

# CCPA-30-1

## FICHE TECHNIQUE / SPEC SHEET

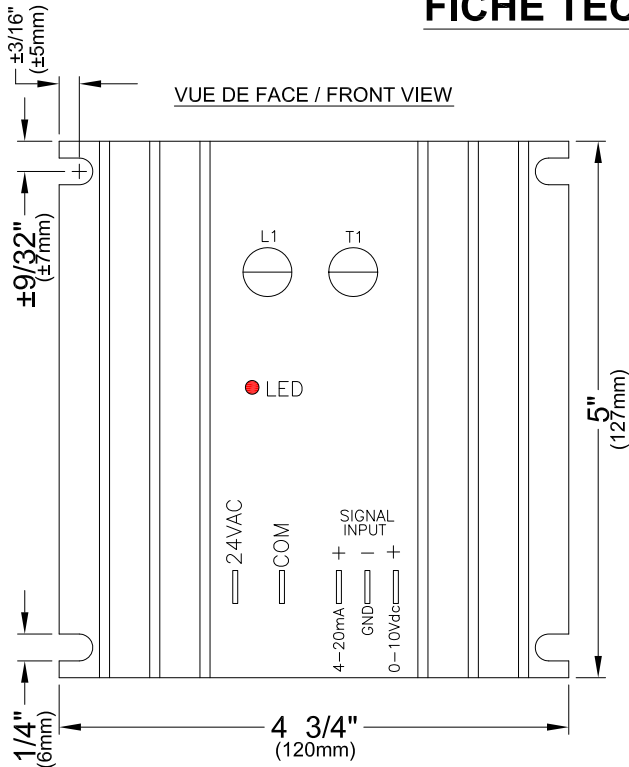

**SPECIFICATIONS:**  
**MODULE DE PUISSANCE / POWER MODULE :** TYPE SCR  
**RADIATEUR / HEATSINK :** TYPE MS-15170  
**SIGNAL DE CONTRÔLE / CONTROL SIGNAL :** 0-10VDC OU/OR 4-20mA  
**ALIMENTATION REQUISE / REQUIRED SUPPLY :** 24VAC  
**CONTRÔLE MODULANT / MODULATING CONTROL :** TYPE PHASE ANGLE  
**MODÈLE / MODEL :** CCPA-30-1  
**COURANT MAX. / MAX. AMPERAGE :** 30A  
**VOLTAGE :** 48 - 600VAC, 1 PHASE, 50-60 Hz

↑  
**DIRECTION D'AIR /**  
**AIR FLOW**

L1 = LIGNE / LINE  
 T1 = CHARGE / LOAD

VUE DE CÔTÉ / SIDE VIEW

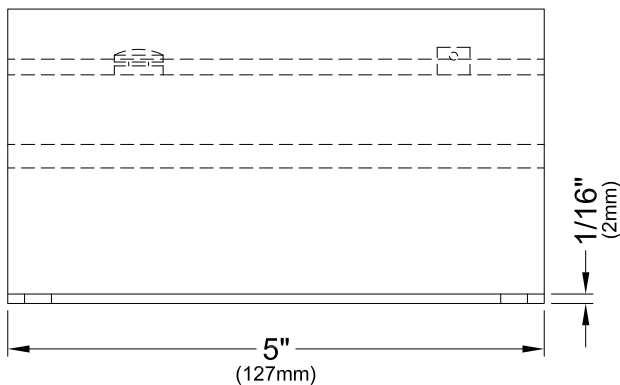

VUE DU BAS / BOTTOM VIEW

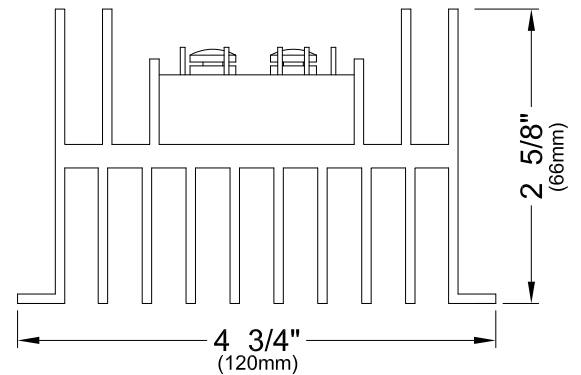

**CRISTAL**

2025 LAVOISIER #135  
 QUEBEC, QC, CANADA  
 G1N 4L6  
 TEL: 1-800-681-9590  
 FAX: 1-418-681-7393  
[www.cristalcontrols.com](http://www.cristalcontrols.com)



CAN/CSA-C22.2 NO. 14-M95  
 -APPAREILLAGE INDUSTRIEL DE COMMANDE  
 UL Std No. 508  
 -INDUSTRIAL CONTROL EQUIPMENT

- PROPOSITION
- APPROBATION
- INFORMATION

Préparé par: LT, Vérifié par: PC

DESSIN / DRAWING :

CCPA-30-1

DATE :

MARS 2012