

# CCS-30-3

## FICHE TECHNIQUE / SPEC SHEET

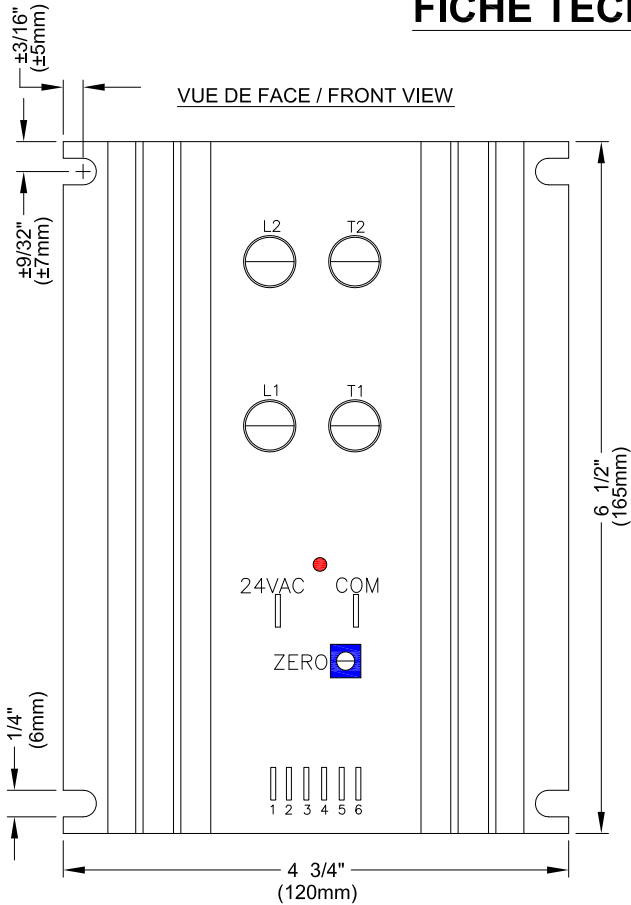

**SPECIFICATIONS:**

**MODULE DE PUISSANCE / POWER MODULE :** TYPE SCR

**RADIATEUR / HEATSINK :** TYPE MS-15170

**ALIMENTATION REQUISE / REQUIRED SUPPLY :** 24VAC

**SIGNAL DE CONTRÔLE / CONTROL SIGNAL :** 0-5Vdc, 0-10Vdc,  
0-135 ohms & 4-20mA

**MODÈLE / MODEL :** CCS-30-3

**COURANT / AMPERAGE :** 30A

**VOLTAGE :** 48VAC - 600VAC, 3 PHASES (2 LEGS), 50-60 Hz

**OPÉRATION PAR PASSAGE À ZÉRO / ZERO-CROSS OPERATION**



**DIRECTION D'AIR /  
AIR FLOW**

L1 & L2 = LIGNES / LINES  
T1 & T2 = CHARGES / LOADS

VUE DE CÔTÉ / SIDE VIEW

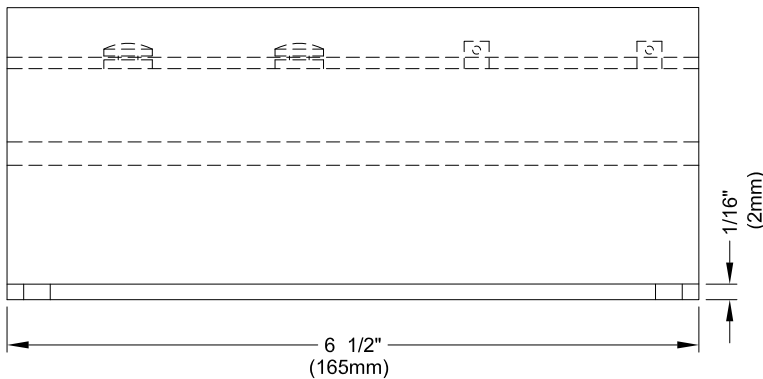

VUE DU BAS / BOTTOM VIEW

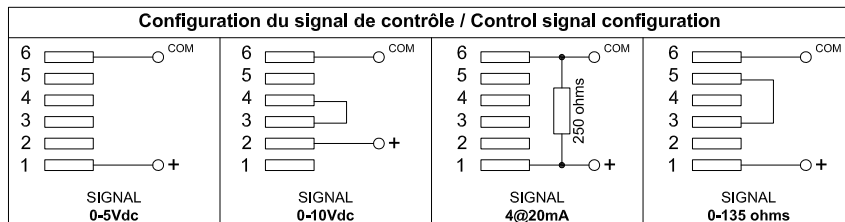
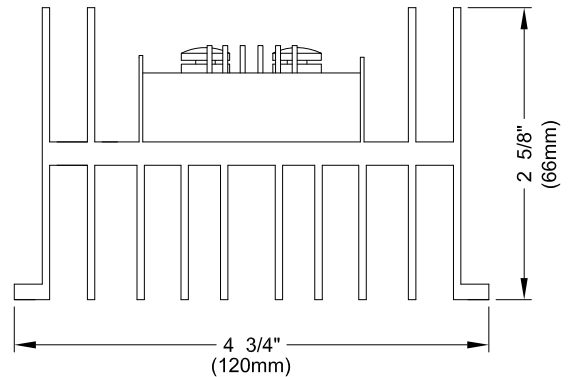

**CRISTAL**

2025 LAVOISIER #135  
QUEBEC, QC, CANADA  
G1N 4L6  
TEL: 1-800-681-9590  
FAX: 1-418-681-7393  
[www.cristalcontrols.com](http://www.cristalcontrols.com)



CAN/CSA-C22.2 NO. 14-M95  
-APPAREILLAGE INDUSTRIEL DE COMMANDE  
UL Std No. 508  
-INDUSTRIAL CONTROL EQUIPMENT

- PROPOSITION
- APPROBATION
- INFORMATION

Préparé par: LT, Vérifié par: PC

DESSIN / DRAWING :

CCS-30-3

DATE :

MARS 2012